



ARBOR  
LONDON SE1

BANKSIDE YARDS



View north/east on typical office floor

Typical office floor (with terrace)

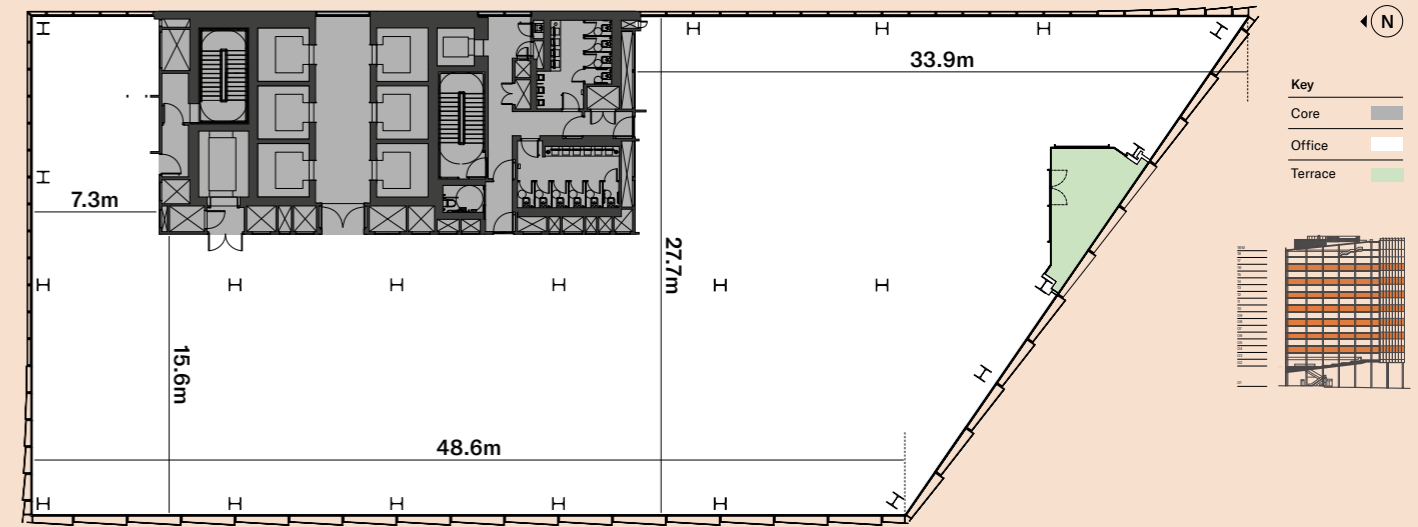

Typical floor terrace

Area schedule

	NIA sq ft	Terrace sq ft
Level 19	Wipro	
Level 18	Wipro	
Level 17	Under offer	Wipro
Level 16	Merlin Entertainments	
Level 15	13,782	
Level 14	13,519	265
Level 13	13,766	
Level 12	Veson Nautical	
Level 11	13,777	
Level 10	Smiths Group	
Level 9	Winckworth Sherwood	
Level 8	Winckworth Sherwood	
Level 7	Lewis Silkin	
Level 6	Lewis Silkin	
Level 5	The Carbon Trust	
Level 4	Flutter Ent.	5,896   264
Level 3	Flutter Entertainment	
Level 2	Flutter Entertainment	
<b>Total Available</b>	<b>60,740</b>	

Spec at a glance

- Platinum BREEAM Excellent
- Carbon zero in operation WELL Ready to achieve Platinum
- 2.91m floor to ceiling heights (3m+ with exposed ceiling) 1:8 Occupational density (1:6 possible on two floors)
- Warm down / exercise room 3m span windows and low iron glass
- 330 cycle spaces (Bike maintenance & water station) 28 showers 377 lockers (including 5 drying lockers)



View west on typical office floor

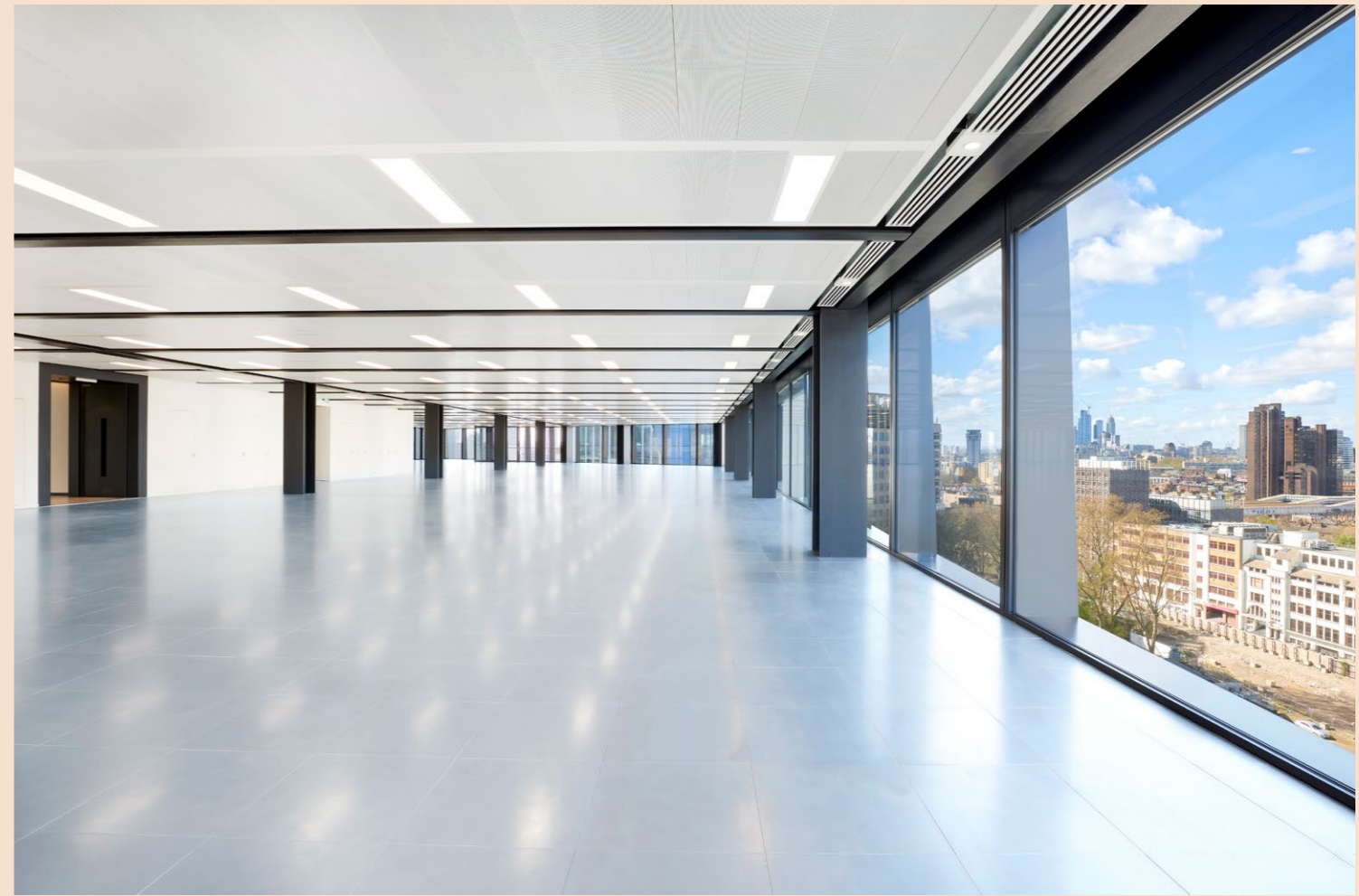

Indicative Cat A finish on a typical office floor



Lift lobby on Level 1



Wellness room

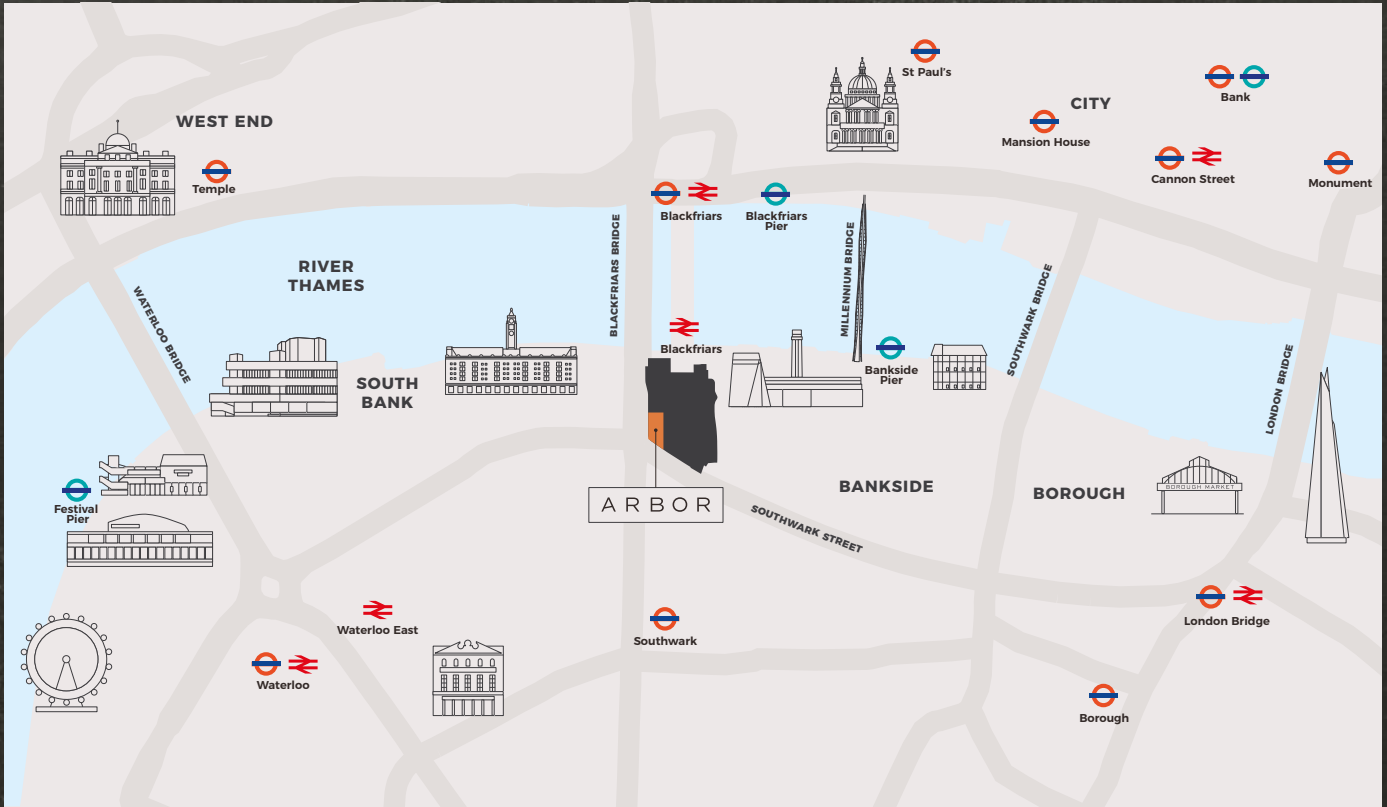

## Leasing agents



**Angus Goswell**  
07717 343151  
angus.goswell@knightfrank.com

**William Foster**  
07748 985951  
william.foster@knightfrank.com

**Toby Pritchard-Davies**  
07468 724284  
toby.pritchard-davies@knightfrank.com

**Daniel Brownlee**  
07971 061119  
daniel.brownlee@knightfrank.com



**James Heyworth-Dunne**  
07779 327071  
jhd@inglebytrice.co.uk

**Veronika Sillitoe**  
07966 029048  
v.sillitoe@inglebytrice.co.uk

**Charles Ingleby**  
07970 026471  
c.ingleby@inglebytrice.co.uk

## BANKSIDE YARDS

A DEVELOPMENT BY  
NATIVE LAND AND PARTNERS



HOTEL PROPERTIES LIMITED



Amcorp Properties  
Berhad

TEMASEK

[banksideyards.com/arbor](https://banksideyards.com/arbor)

Important notice: (i) the particulars are set out as a general outline only for guidance of intending purchasers or lessees and do not constitute, nor part of, an offer or contract (ii) all descriptions, dimensions, references to condition and necessary permission for use and occupation, and other details are given in good faith and are believed to be correct, but any intending purchasers or occupiers should not rely on them as statements or representations of fact, but must satisfy themselves by inspection or otherwise as to the correctness of each of them. August 2024.